

New User Registration Process

Go to chicagoliveshealthy.com/new to access the RealAge test.

1



CLICK THIS BUTTON

Scroll to the bottom of the page and click **CLICK HERE TO CREATE A NEW ACCOUNT AND BEGIN THE REALAGE TEST**.

3

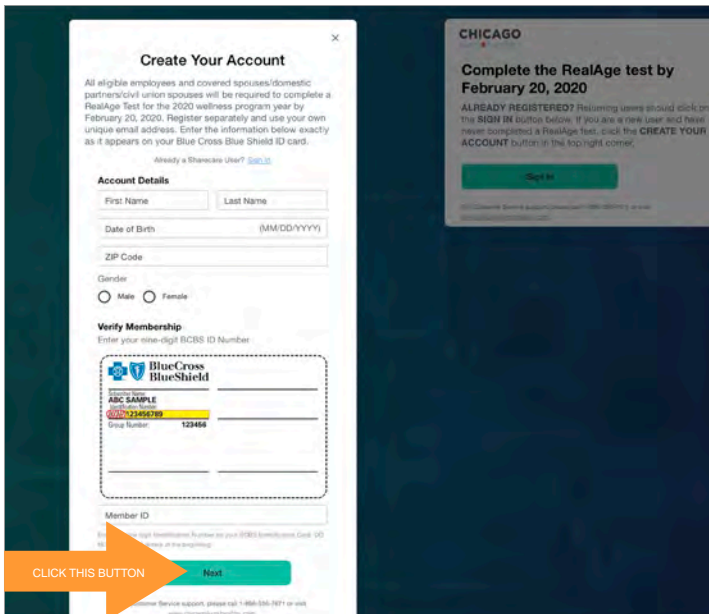

CLICK THIS BUTTON

Enter your first and last name, date of birth, zip code and gender. In the Member ID field at the bottom of the page, enter the nine-digit identification number found in the top left corner of your BCBS identification card, DO NOT enter the 3 letters at the beginning—only the nine numbers, click **NEXT**.

2

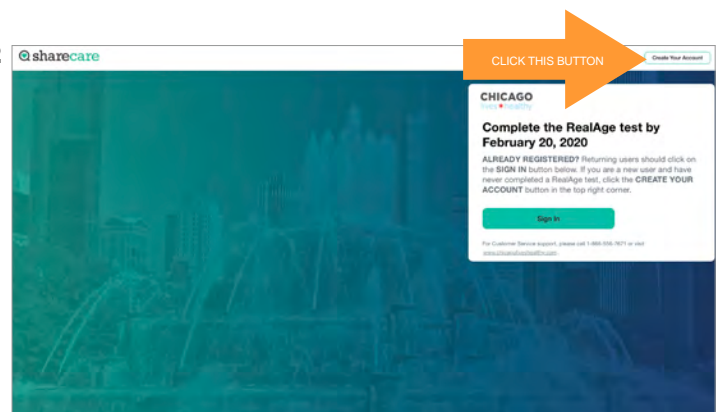

CLICK THIS BUTTON

Click the **CREATE YOUR ACCOUNT** button in the top right-hand corner. (It is important to confirm you are on the correct website. The image in the background on this page should be the Buckingham Fountain.)

4

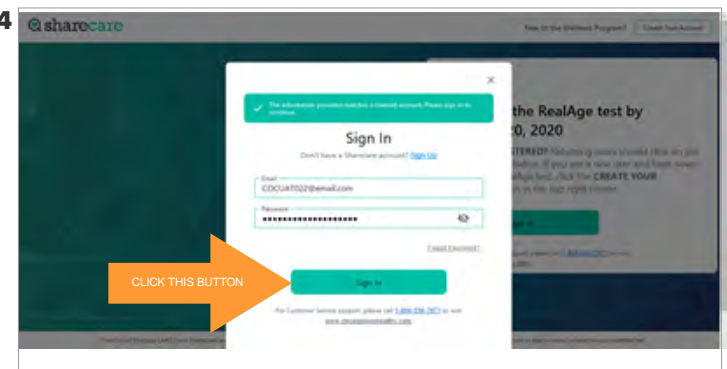

CLICK THIS BUTTON

Choose your login credentials by entering a unique email address and password. Click **SIGN IN**.

New User Registration Process (continued)

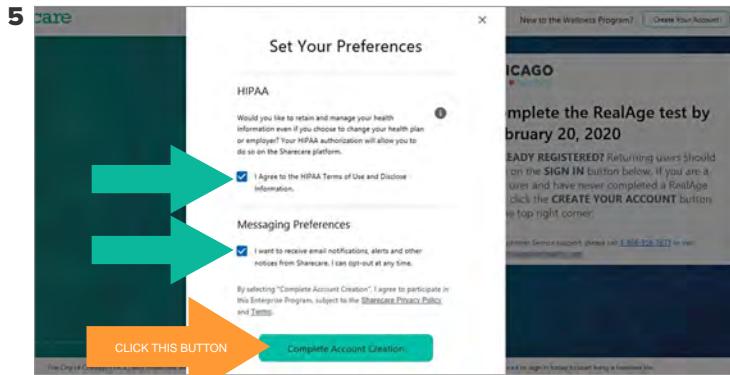

Select your preferences. Once completed, click **COMPLETE ACCOUNT CREATION**.

- a. If you wish to retain your biometric information should you leave the program, confirm by checking the box under HIPAA.
- b. If you wish to receive email reminders on wellness program deadlines and participation requirements, confirm that the box under Messaging Preferences is checked.

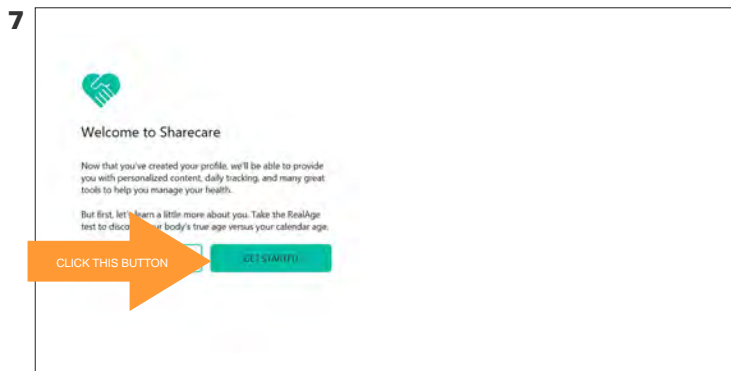

Click **GET STARTED** to complete the RealAge test for the 2020 wellness program year.

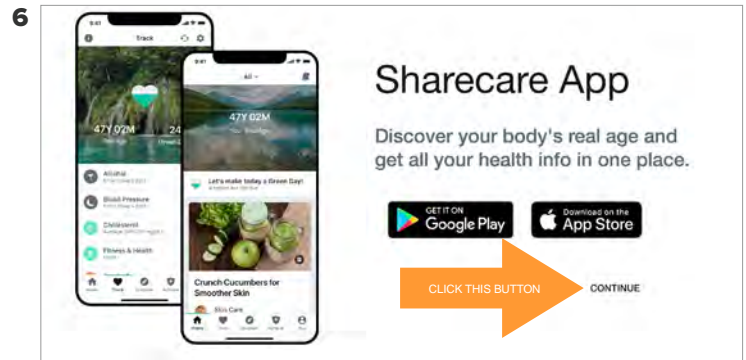

Click **CONTINUE** to skip the Sharecare app page.